

SERVICE PROCEDURES / ADDING OIL

ADDING OIL TO A DISCHARGED SYSTEM USING AN OIL INJECTOR

1. Connect the manifold gauge set, oil injector and vacuum pump as shown in the diagram. **DO NOT RUN ENGINE!** Make certain that all valves are in their "closed" position, and refrigerant is evacuated from the system.
2. Turn on vacuum pump and open "High" Side Control Valve (B) on the Manifold Gauge Set.
3. With "Low" Side Valve (A) and Oil Injector Valve (C) closed, unscrew the Oil Injector cap and add 1 or 2 ozs. of refrigerant oil as required. Replace cap.
4. After 29 In. Hg. of vacuum has been reached, open Oil Injector Valve (C). Continue running vacuum pump. Oil will be drawn into the air conditioning system. If additional oil is required, repeat the above sequence.
5. Before recharging, completely evacuate the air conditioning system for a minimum of 45 minutes after 29 In. Hg. has been reached.

WARNING! Do not use with different oils without first thoroughly removing all traces of original oil.

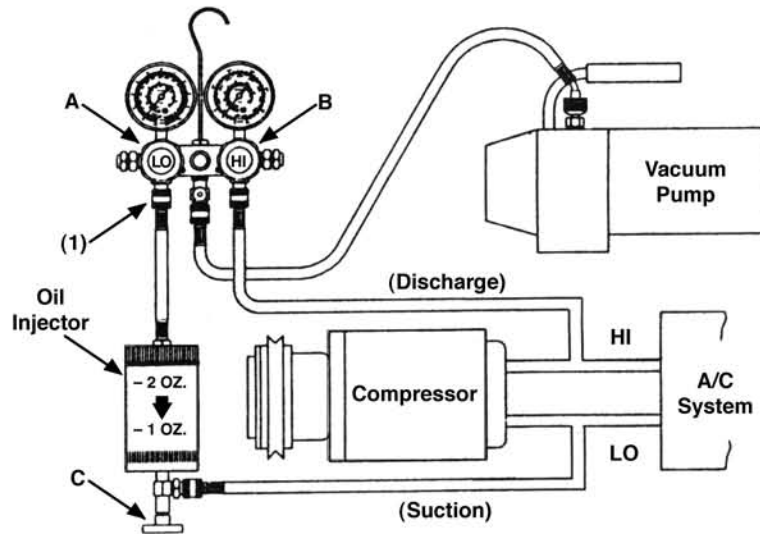

Parts Breakdown of Oil Injector

82375 - Complete Oil Injector (R134a)

90375 - Complete Oil Injector (R12)

(Note: Specify R12 or R134a)

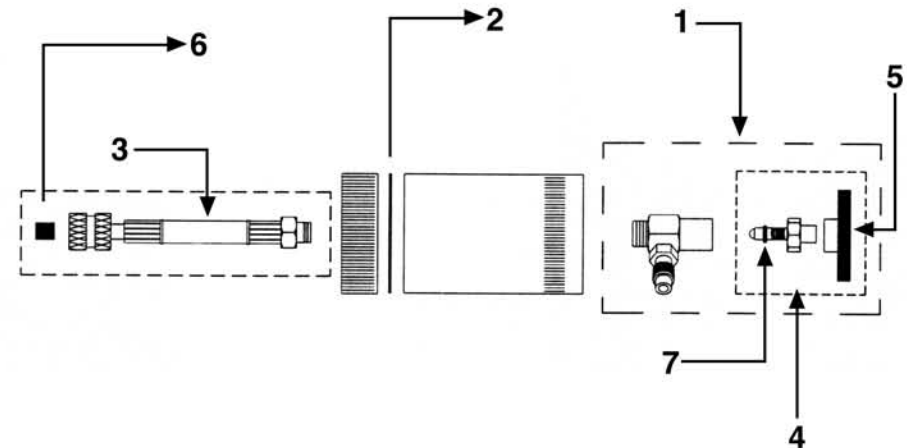

Fig.	Mastercool Part #	Description
1.	8375-004.....	Control Valve Assembly-Complete (R134a)
	0375-004.....	Control Valve Assembly-Complete (R12)
2.	0375-005-R.....	Oil Gasket (R134a & R12)
3.	8375-A.....	Hose Assembly w/Nut Gasket (R134a)
	0375-A.....	Hose Assembly w/Nut Gasket (R12)
4.	0375-024.....	Valve Stem Assembly Includes Knob (R134a & R12)
5.	0375-007.....	Knob Only (R134a & R12)
6.	82010.....	Gasket for Hose Nut (R134a)
	42010.....	Gasket for Hose Nut (R12)
7.	0375-004-OR.....	O-Ring (Valve Stem R134a & R12)
8.	82375.....	Complete Oil Injector (R134a)
9.	90375.....	Complete Oil Injector (R12)